

Packing List

Item	Name	Quantity
1	Camera head	1pcs
2	Cable reel	1pcs
3	DVR control unit	1pcs
4	Video Link cable(6pin)	1pcs
5	Meter counter link cable(8pin)	1pcs
6	Camera skid	1set
7	Pan tilt rotation holder	1pcs
8	Fixation clamp	1pcs
9	32G USB disk	1pcs
10	Charge adaptor	1pcs
11	User manual	1pcs
12	USB wireless keyboard	1pcs
13	Tool bag	1pcs

VS-729 PIPE CAMERA INSPECTION SYSTEMS ASSEMBLY AND OPERATING INSTRUCTION



**Read these instructions completely before operating the device
PLEASE CHARGE BATTERY FIRST BEFORE USE!**

Specification

Monitor		
Screen size	8inch LCD IPS screen	
Display Ratio	16:9	
Resolution	1280X720	
Menu	Chinese English and others	
Sunshade function	Yes	
HD DVR		
Support playback file format	video	H.264 encode, MP4 format
	Audio	audio and video
	Picture	JPEG
Audio input	External Microphone	
Video input	AHD analog high-definition signal(support)	
Signal input	CAM	
Video system	AHD PAL、AHD NTSC (Support CVBS	
Power support		
External charge	DC12V	
Battery	12V 7000mA/H	
Complete system power	20W (Max)	
Battery charge time	8hours	
Battery work time	5-6 hours	
Camera head		

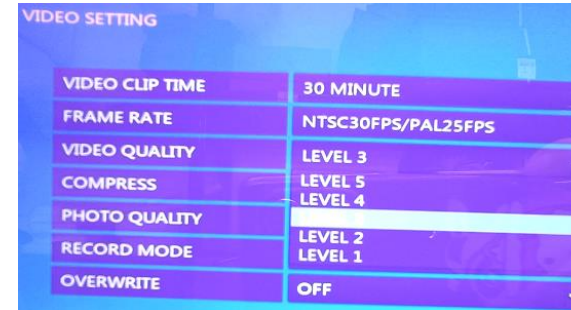

Video clip time:1 MINUTE / 5 MINUTE / 10 MINUTE
15 MINUTE / 30 MINUTE / 60 MINUTE
Default value: 30 MINUTE

FRAME RATE:NTSC 30FPS / PAL 25FPS

Video Quality: It has 5 options. Usually we choose Level 3.
The level is bigger, the video resolution is higher

Compress:H265

Photo Quality: High / Middle / Low
Default Value : High

Record Mode: Manual / Auto
Default Value : Manual

Overwrite:OFF/ON
Default Value : OFF

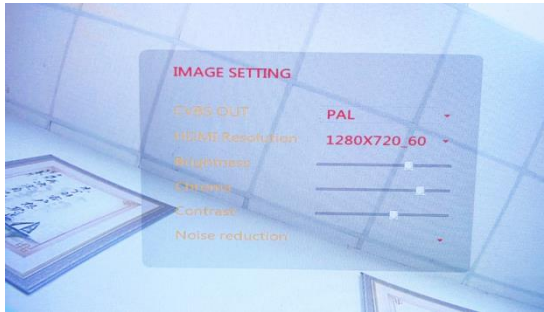

Adjust the LCD screen brightness, Contrast
 Default resolution: 1280x720_60

Usually we suggest the customers don't change these value

RECORD Setting

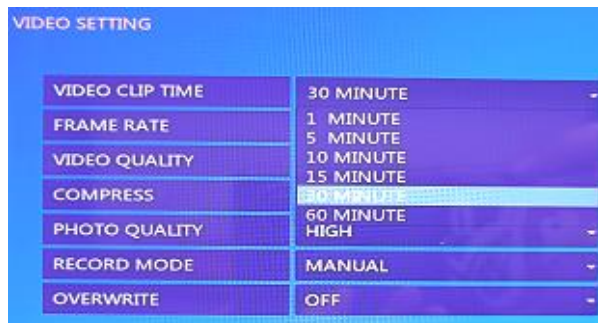

Camera Diameter	Dia.40mm x L60mm
View range	90 degree
Lighting	8pcs white LEDS
Camera Sensor	1/3 CMOS, 1.3MP 960P
Operating temperature	5°C ~ 50°C
Camera housing material	304#Stainless steel
Waterproof	IP68
Cable wheel	
Special gold point touch connector to camera	
Fiberglass rod push cable <input type="checkbox"/> Ø 7mm or <input type="checkbox"/> 9mm	
Cable length: <input type="checkbox"/> 60 meters <input type="checkbox"/> 100 meters <input type="checkbox"/> 120 meters	
Other function	
Meter counter	Feet and Meter switch. Display on the screen
Keyboard	Support wired and wireless keyboard.

Attention

- 1) Please read the user manual carefully
- 2) Please format the USB flash disk or USB hard disk on the DVR control box before first use the product
- 3) Using wireless keyboard, please make sure the battery for keyboard is full. If battery is low, you need to change a new 7th battery.
- 4) Using original charger adaptor to charge battery or support unit work.

Know Your Device

Camera head

1. Aluminum housing
2. Lens
3. White LED lights (8 pcs)

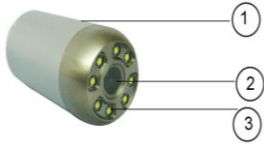

Skid assemble

Step1:



Step2



Step3:



Step4:

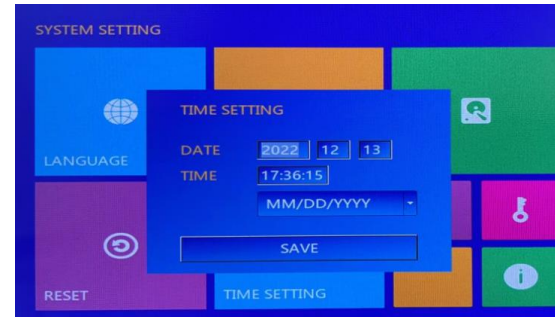

Press UP/Down/Left/Right arrows to set the date and time.
Press "Save" to save the setting

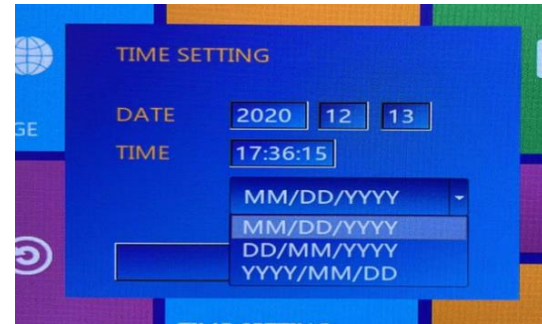

For date format, it has 3 different ways.

IMAGE SETTING

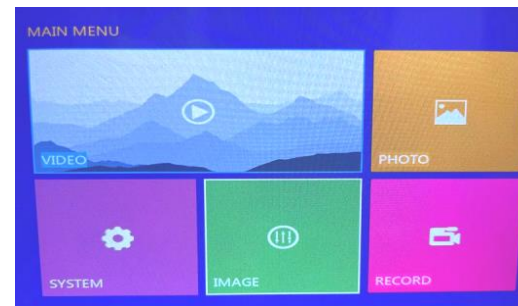

System Setting



1.LANGUAGE: Setting the menu language.

The box has 9 languages.(English,Chinese,French, Espanol German,Polish,Korea,Russian and Italian.

2.ENCODER: Setting the counter value

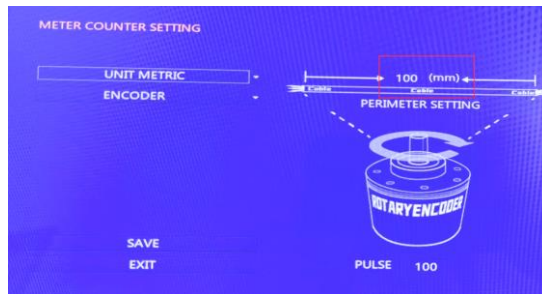

The PREMETER SETTING value is different for different cables.

For 7mm/9mm fiberglass cable, it is 100

3.DISK: Format the USB flash driver.



4.RESET:Restore the factory default Settings

5.TIME Setting:Setting the time,date

10

DVR Control Unit

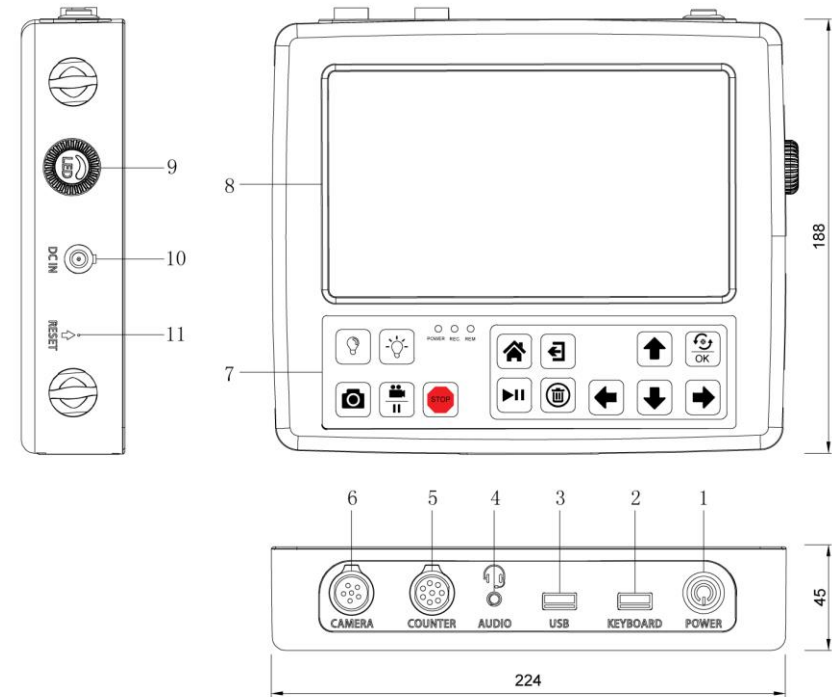

No	Name	Function	How to use
1	POWER	On/Off	Press the button for 3 seconds to turn on /off the control box
2	KEYBOARD	Connect wireless /wired keyboard	Insert 2.4G wireless keyboard adaptor
3	USB	Connect USB disk	Insert external USB disk to record and save the video& picture files. Please don't remove the USB flash disk when it is recording.
4	AUDIO	Earphone/Microphone	Insert the 3.5mm earphone

5	COUNTER	Meter counter	Use 8pin link cable, one port to "COUNTER" port, the other to cable reel "Meter counter port".
6	CAMERA	Signal input	Connect 6pin link cable to cable reel
7	CONTROL PANEL	DVR MENU	Details reference picture(1-1)
8	MONITOR	Display the image	8inch HD screen ,1280x720 resolution
9	LED DIMMER	Adjust the camera LED brightness	Adjust 18mm, 23mm,29mm,40mm and 55mm camera LED brightness
10	DC IN	Charge for the battery	Connecting extra charge adaptor
10	RESET	Restart the DVR unit	When the system is halted

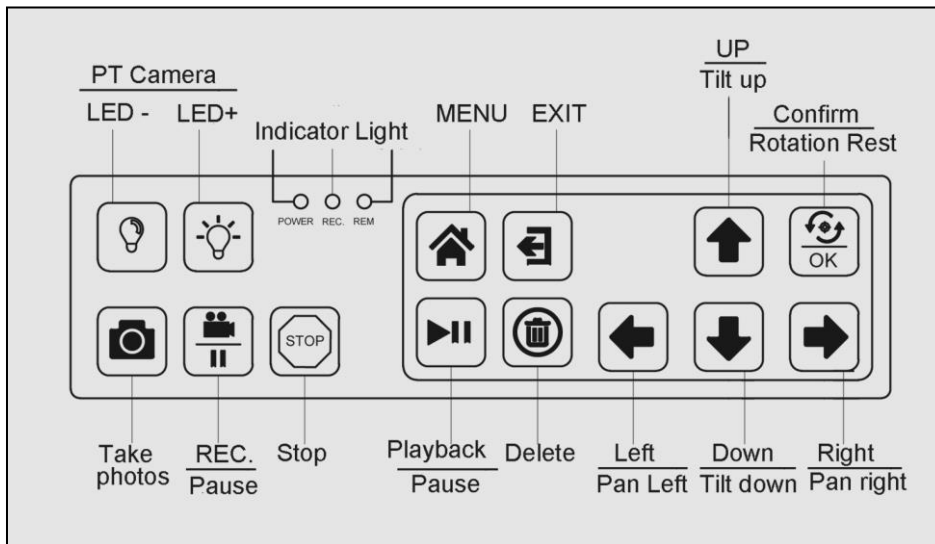

(1-1)

DVR menu instructions

Press menu button to enter the main menu

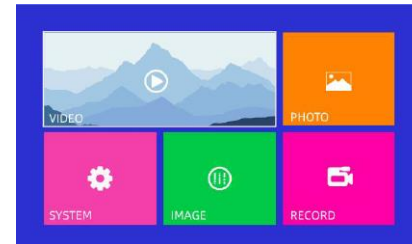

1. Video: Playback the video file

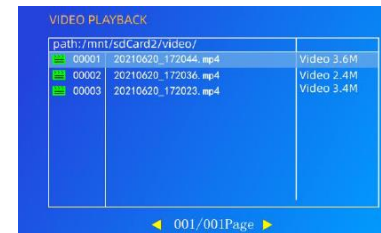

Press the "UP" and "DOWN" keys to select files

Press the "LEFT" and "RIGHT" keys to turn pages,

Press "OK" key to play the file, "STOP, DEL key" to delete files.

2.PHOTO: Playback the picture file

3.SYSTEM:Setting language,date,time ...

4. IMAGE: Image setting,such as CVBS out, HDMI

Resolution,brightness,chroma, contrast, noise reduction

5.RECORD: Video setting, such as video clip time, frame rate, compress, photo quality, record model,overwrite.



2. Connect the camera head to cable reel.
3. Connect the link cable to cable reel .
 8pin link cable is for meter counter
 6pin link cable is for camera signal input



DVR remote controller



Button	Function
REC	Recording video
SNAP	Screenshot / Photography
▲	Up
▼	Down
◀	Left/Backward(Playback Model)
▶	Right/Forward(Playback Model)
OK	Confirm
MENU	DVR menu
STOP	Stop recording
ESC	Exit
PLAY	Playback the video
DEL	Delete the video or picture file

Cable reel part

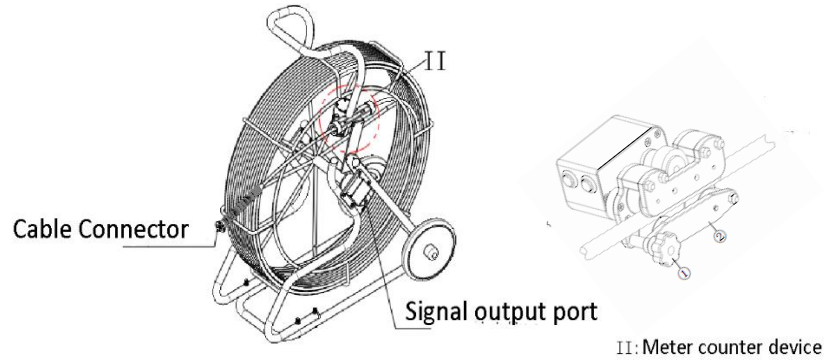

7mm/9mm Fiberglass cable reel

Fixing the cable to meter counter slot

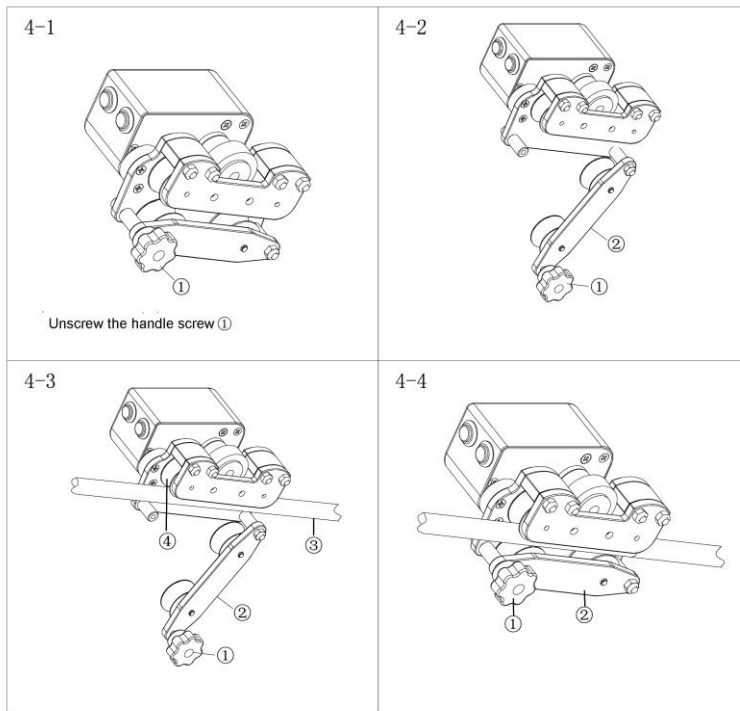

Meter counter device part

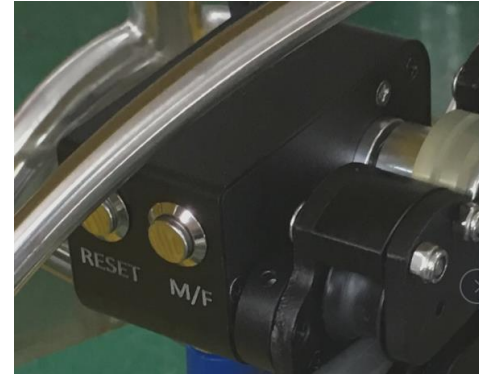

No.	Function	Details
1	RESET	Press this button ,the counter is zero
2	M/F	Switch Meters and Feet ; Default value is Meters

How to assemble the complete system

1. Take out the fiberglass from the reel, install it to meter counter device.
2. Connect camera head to cable reel.
3. Install the working platform to the cable reel.(1-1)
4. Take out the USB adaptor from the keyboard. Install the 7th battery.
Put the keyboard into the platform. (1-2)

